



T-TYPE SEDIMENT STRAINERS



JS Series

JS 300
Size: 1/2" - 8"

● MATERIALS OF CONSTRUCTION

MATERIAL	U-PVC, PP, CPVC, PPG, PVDF
SIZES	1/2", 3/4", 1", 1-1/4", 1-1/2", 2", 2-1/2", 3", 4", 5", 6", 8"
END CONNECTIONS	Flange ends with in JIS; DIN; ANSI; BS STANDARD
WORKING TEMP	U-PVC: 0°C~60°C, PP: -20°C~90°C, PPG: -20°C~100°C, CPVC: 0°C~90°C, PVDF: -40°C~120°C

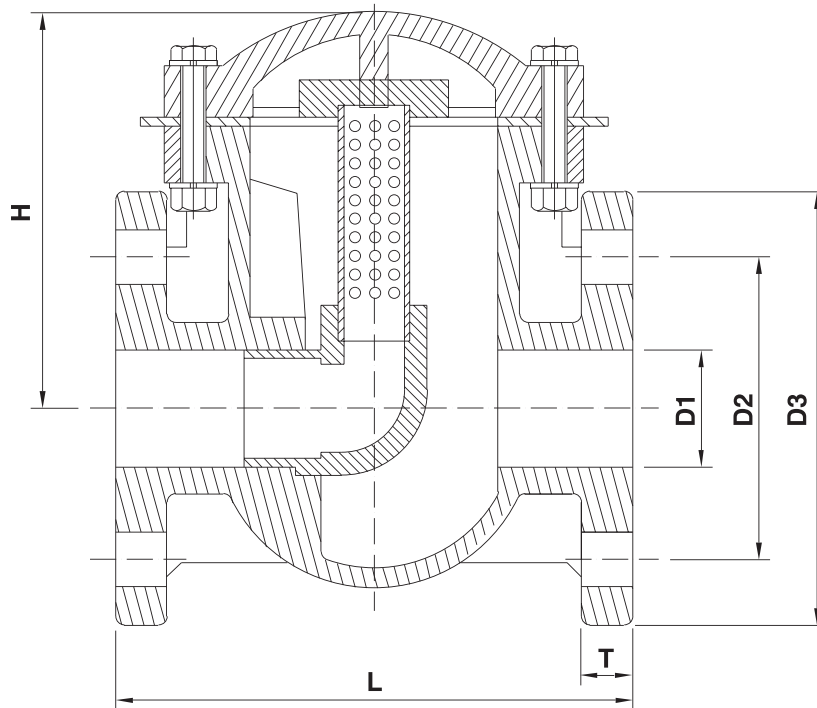

DN15~DN200

● DIMENSIONS TABLE

Nom. Size DN-inch	D1	L	D2			D3			T	H	SCREEN (mm)	Test Press		Working Press	
			JIS	DIN	ANSI (inch)	JIS	DIN	ANSI (inch)				kg/cm ² (bar)	lb/in ²	kg/cm ² (bar)	lb/in ²
15(1/2")	25	160	70	65	2.38	95	95	3.50	15	129	2.5	15	225	10	150
20(3/4")	25	160	75	75	2.76	100	105	3.86	15	129	2.5	15	225	10	150
25(1")	25	160	90	85	3.13	125	125	4.25	15	129	2.5	15	225	10	150
32(1-1/4")	41	180	100	100	3.50	135	135	4.60	18	141	2.5	15	225	10	150
40(1-1/2")	41	180	105	110	3.88	150	150	5.91	18	141	2.5	15	225	10	150
50(2")	52	200	120	125	4.74	155	155	6.10	18	165	2.5	15	225	10	150
65(2-1/2")	80	260	140	145	5.49	175	175	6.88	22	180	2.5	15	225	10	150
80(3")	80	260	150	160	6.00	185	190.5	7.87	22	180	2.5	15	225	10	150
100(4")	100	300	175	180	7.50	234	234	9.21	24	216	2.5	10	150	7	105
125(5")	125	350	210	210	8.50	250	250	9.84	24	239.5	2.5	10	150	7	105
150(6")	150	400	240	240	9.51	289	289	11.38	30	273	2.5	10	150	7	105
200(8")	200	500	290	295	11.75	330	330	12.99	30	310	2.5	10	150	7	105

✳ The dimension table is calculated based on PVC material.
 ✳ The valve of test pressure is calculated based on PVC PVDF materials.
 ✳ The valve of test pressure for PP material is 70% based on the table.
 ✳ The flanged length tolerance is according to EN558-1:1995.